

, solder terminal, Socket, 6.3 mm, 2-pole, DC Plug/Socket



See below:

Approvals and Compliances

Description

- Solder :
Screw-on mounting , rear-side
- Low Voltage DC Plug and Socket
- DC Plug: 2-pole , straight

Weblinks

[pdf data sheet](#), [html datasheet](#), [General Product Information](#), [Distributor-Stock-Check](#), [Detailed request for product](#)

Technical Data

Diameter	6.3 mm / 2.0 mm	Allowable Operation Temperature	-20 °C to 70 °C
Number of Poles	2-pole	Terminal	solder terminal silver plated
Ratings DC	0.5 A / 12 VDC	Mounting	Screw-on mounting wall thickness max. 5.5 mm
Dielectric Strength	500 VDC	Style	straight
Insulation Resistance	> 100 MΩ @ 500 VDC	Lifetime	5000 Insertions
Pull Force	4 - 20 N		



Approvals and Compliances

Detailed information on product approvals, code requirements, usage instructions and detailed test conditions can be looked up in [Details about Approvals](#)

SCHURTER products are designed for use in industrial environments. They have approvals from independent testing bodies according to national and international standards. Products with specific characteristics and requirements such as required in the automotive sector according to IATF 16949, medical technology according to ISO 13485 or in the aerospace industry can be offered exclusively with customer-specific, individual agreements by SCHURTER.

Compliances

The product complies with following Guide Lines

Identification	Details	Initiator	Description
	RoHS	SCHURTER AG	Directive RoHS 2011/65/EU, Amendment (EU) 2015/863
	China RoHS	SCHURTER AG	The law SJ / T 11363-2006 (China RoHS) has been in force since 1 March 2007. It is similar to the EU directive RoHS.
	REACH	SCHURTER AG	On 1 June 2007, Regulation (EC) No 1907/2006 on the Registration, Evaluation, Authorization and Restriction of Chemicals 1 (abbreviated as "REACH") entered into force.

Dimensions [mm]

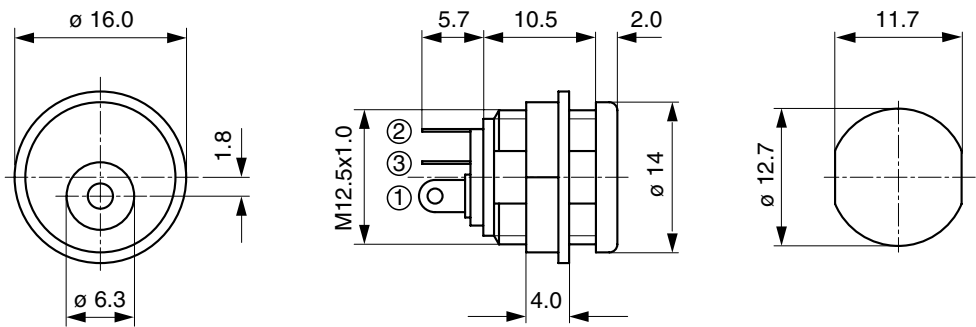

Diagrams

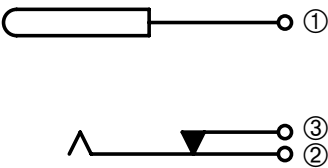

Variants

Product group	Diameter [mm]	Number of Poles	Terminal	Order Number
DC Plug/Socket	6.3	2-pole	solder terminal	4840.2200

Availability for all products can be searched real-time: <https://www.schurter.com/en/info-center/support-tools/stock-check-distributors>

Packaging unit 250 Pcs

Mating Inlets/Plugs

Category / Description

[DC Plugs / Sockets Overview complete](#)



, solder terminal, Plug, 5.5 mm, 2-pole, DC Plug/Socket	4840.1200
, Cable, Plug, 5.5 mm, 2-pole, DC Plug/Socket	4840.5200
, Cable, Plug, 5.5 mm, 2-pole, DC Plug/Socket	4840.5201