

IEC Appliance Inlet C10, Screw-on Mounting, Front Side, Solder or Quick-connect Terminal



C10



70 °C

**Description**

- Panel Mount:
- Screw-on mounting, from front side
- Appliance Inlet, Pin temperature 70 °C, Protection class II
- Solder terminals or quick connect terminals

**Approvals**

- VDE Certificate Number: 40009507
- UL File Number: E96454
- CSA File Number: 27324

**References**

This type is Phase-out without alternate type  
Last order possibility: 31.05.2011

**Weblinks**

[pdf](#), [html](#), [General Product Information](#), [Approvals](#), [RoHS](#), [CHINA-RoHS](#), [Mating Connectors](#), [e-Shop](#), [SCHURTER-Stock-Check](#), [Distributor-Stock-Check](#), [Accessories](#), [Detailed request for product](#)

**Technical Data**

Ratings IEC	6 A / 250VAC; 50Hz	Appliance Inlet	C10 acc. to IEC/EN 60320-1
Ratings UL/CSA	6 A / 250VAC; 60Hz		UL 498, CSA C22.2 no. 42 (for cold conditions) pin-temperature 70 °C, 6A, Protection Class 2
Dielectric Strength	> 3kVAC between L-N > 1.5kVAC between L/N-PE (1 min/50Hz)		
Allowable Operation Temp.	-25 °C to 70 °C		
Degree of Protection	from front side IP 20 acc. to IEC 60529		
Protection Class	Suitable for appliances with protection class 2 acc. to IEC 61140		
Material: Housing	PA, black / grey / white, UL 94V-0		

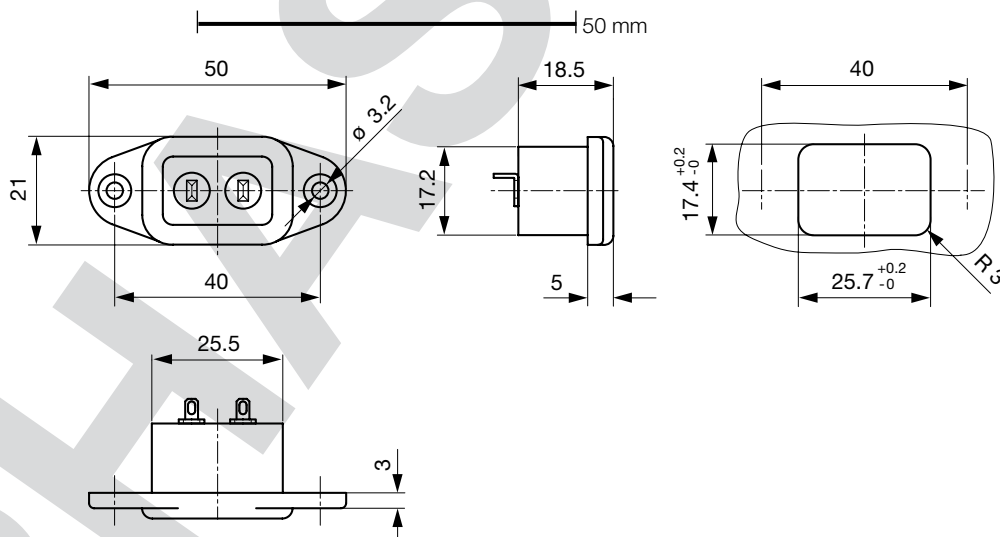
**Dimensions**

Length of the terminal please find at the order code configuration table

## Config. Code

6075 - H - A B C 0 - D - E

The characters are placeholders for the correspondingly keys of selections from the key tables.

6075 - **H** - A B C 0 - D - E = Type

Type	Configuration key
protection class 2	B

6075 - H - **A** B C 0 - D - E = Terminals

Terminal L	Configuration key
short solder terminal (L = 4.8 mm)	2
long solder terminal (L = 8.5 mm)	3
Blade terminal (4.8 x 0.8 mm)	8
Blade terminal (6.3 x 0.8 mm)	9

6075 - H - A **B** C 0 - D - E = Terminals

Terminal N	Configuration key
short solder terminal (L = 4.8 mm)	2
long solder terminal (L = 8.5 mm)	3
Blade terminal (4.8 x 0.8 mm)	8
Blade terminal (6.3 x 0.8 mm)	9

Symbols similar as in table A

6075 - H - A B **C** 0 - D - E = Terminals

Terminal Ground	Configuration key
without terminal	0

Symbols similar as in table A

6075 - H - A B C 0 - **D** - E = Color

Color	Configuration key
Black	A
Grey	B
White	D

6075 - H - A B C 0 - D - **E** = Style

Style	Configuration key
flange with countersunk holes	1
flange with through holes	2

**Packaging unit** 50 Pcs

## Mating Outlets/Connectors

Category / Description



[Plug Overview complete](#)

IEC Connector C9, Rewireable Appliance Internal

3017

[Plug further types to6075](#)



[Power Cord Overview complete](#)

Power Cord with IEC Connector C9, Straight

3016

Power Cord with IEC Connector C9, Angled

9011

[Power Cord further types to6075](#)